

# COVID-19 Screening In the Harvard Public Schools

## Vision Statement:

The Harvard Public Schools community, dedicated to educational excellence, guides all students to realize their highest potential by balancing academic achievement with personal well-being in the pursuit of individual dreams. The students engage in learning how to access and apply knowledge, think critically and creatively, and communicate effectively. They develop the confidence and ability to understand diverse perspectives, collaborate, and contribute, to their local, national, and global communities.



Shannon Molloy, School Committee Vice Chair

Liz Ruark, Covid-Safe Schools

Toby Bazarneck, Covid-Safe Schools

Colleen Nigzus, School District Lead Nurse

District Leadership Team

# Why Screening Is So Important

- Find and quarantine people without symptoms before they can spread the virus
- Prevent disease spread in the greater community
- Additional evidence that anti-COVID procedures and practices are working
- Peace of mind
- Provides data that can be used to inform future school policies

## Why January 4th?

- Reduces risks from holiday gatherings and travel
- Enables us to remain in our hybrid learning model
- Keeps the buildings clear of the virus for extra days
- Takes advantage of the return from vacation
- Helps us collect permission slips, answer questions, and show parents what is happening with the tests
- Gives our nurses the day to focus on the testing
- Provides more time to develop our plan for in-school testing

# Screening Is One Piece of the Safety Puzzle

- Not a magic bullet
- Masking, distancing, and hand-washing remain CRUCIAL

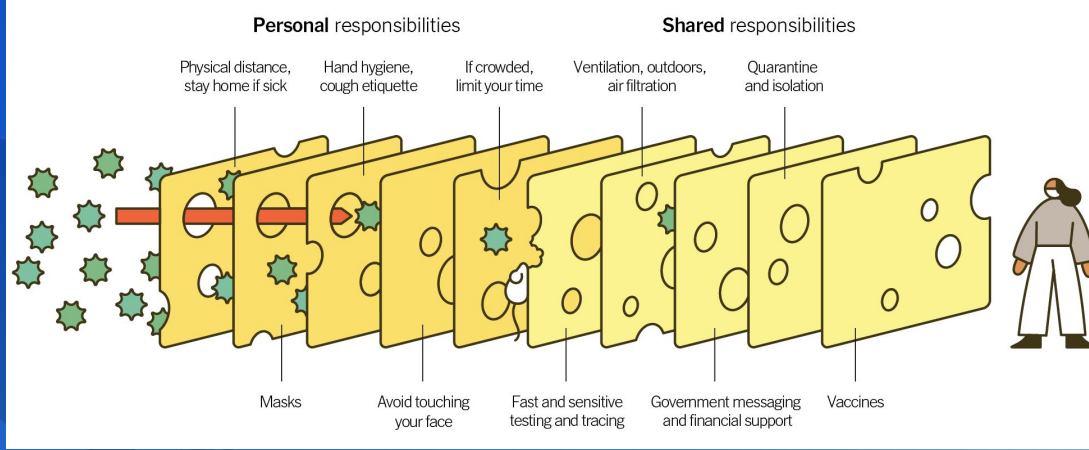
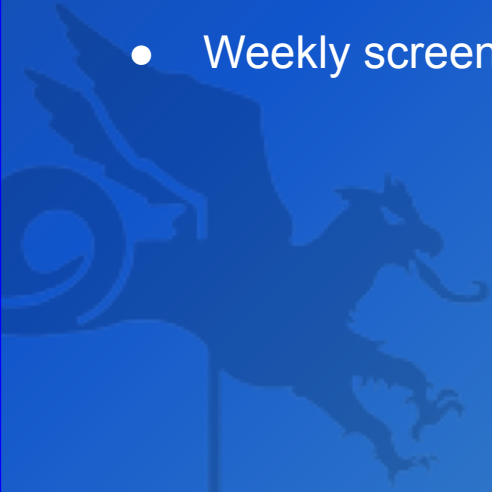

Image by Rose Wong, NY Times; adapted from Ian M. Mackay (virologydownunder.com) and James T. Reason

# Participation, Privacy, and Frequency

- Screening is voluntary
- Based on surveys, at least 80% of families and staff want to participate
- Individuals' privacy will be maintained
- Weekly screening as long as funding available



# Pooled PCR Tests at the Broad Institute

- PCR test (“gold standard”)
- Colleges, universities
- K-12 public schools
- Pooled testing



# Pooled Screening Costs Less

Ten Samples → Ten Tests

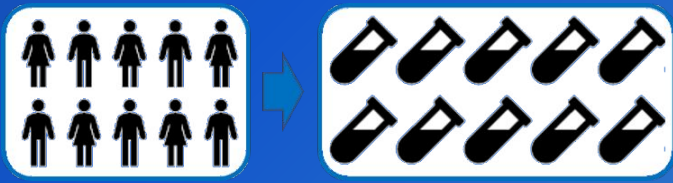

\$\$\$

Ten Samples → One Pooled Test

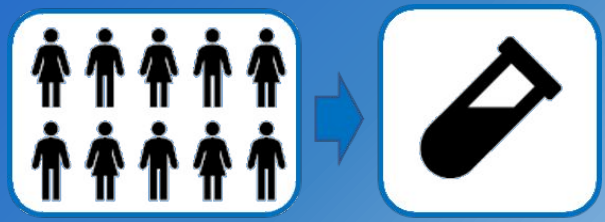

\$



# Positive Pools

Six Pools: One Is Positive



Ten Individual Tests

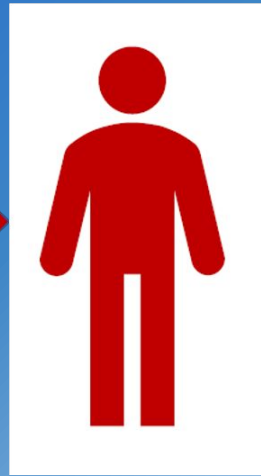
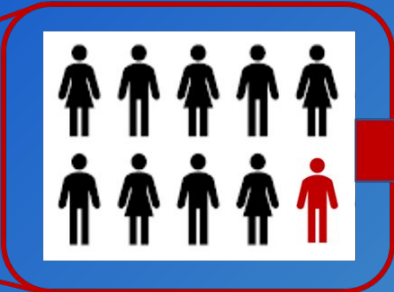

# Collection Process



## Participant should blow their nose

Thoroughly blow and wipe nose to clear thick mucus (snot).

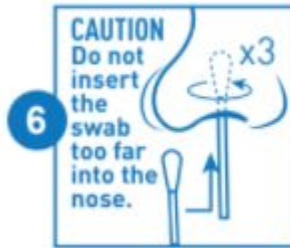

## Collect sample from nostril.

Insert the swab into one nostril **just until the soft tip is no longer visible**. Rotate it in a circle around the inside edge of your nostril 3 times.

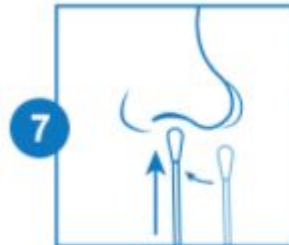

## Collect sample from other nostril.

Use the same soft tip to repeat the previous step in the second nostril 3 times.

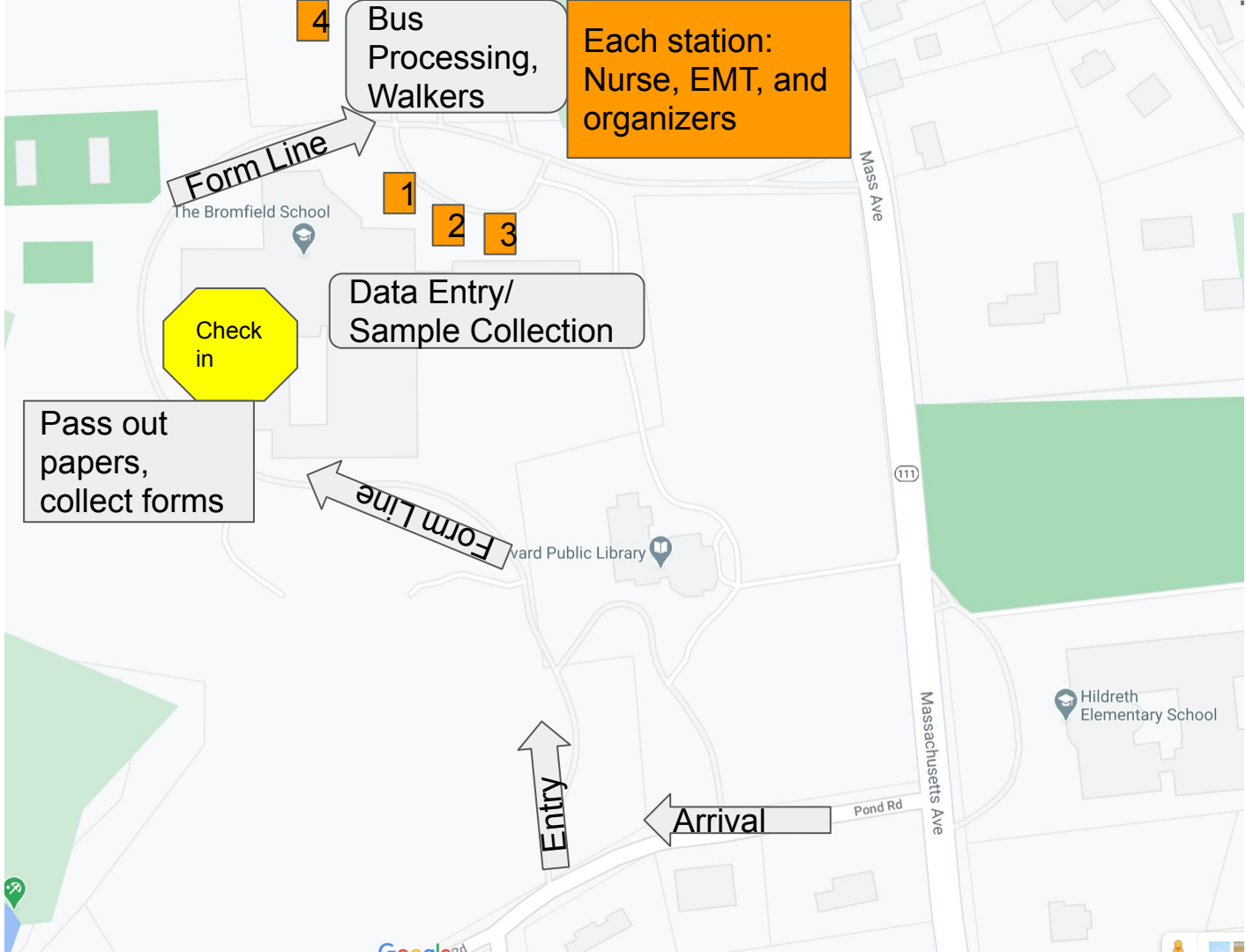

4  
Bus  
Processing,  
Walkers

Each station:  
Nurse, EMT, and  
organizers

Form Line

1

2

3

Data Entry/  
Sample Collection

Check  
in

Pass out  
papers,  
collect forms

Form Line

Entry

Arrival

The Bromfield School

Ward Public Library

Hildreth  
Elementary School

Mass Ave

(111)

Massachusetts Ave

Pond Rd

# Directions for Parents

1. Pull forward to the end of line
2. Fill out card with the information shown
3. All individuals being tested need to blow nose and then use hand sanitizer

## ***When you pull forward to testing station:***

1. Remain in car, open door or window
2. Pull down mask to expose nose but leave mouth covered
3. Nurse or trained designee will swab nose
4. Replace mask, pull away carefully

**One sheet per person being tested. Please complete with information of person being tested**

- Last Name \_\_\_\_\_
- First Name \_\_\_\_\_
- Date of Birth \_\_\_\_\_
- Phone Number \_\_\_\_\_

----Do not fill below this line----

VIAL NUMBER \_\_\_\_\_

# Schedule for Monday

## Drive Up Schedule

Grade PK-2: 8:00-9:30

Grade 3-4: 9:30-11:00

Grade 5: 11:00-12:00

Grade 6-7: 12:30-2:00

Grade 8-10: 2:00-3:30

Grade 11- 12 3:30-5:00

## Bus Schedule

### Bus Pick Up Times

TBS Cohort A: regular time

HES: 8:45 AM

TBS Cohort B: 12:00

- Students must wear a mask and have a signed permission slip.
- They will be driven home after the testing.

## Things to Remember for Monday

- Wear masks in the car when you enter Pond Rd
- Bring hand sanitizer and tissues for the process
- Bring a signed copy of the permission slip
- Have a pen or marker in the car to fill out the identification paper
- Bring along car activities as there may be a wait
- Nurses will have trained anyone doing the swab testing
- Please be patient with us as this is all a new process

## Funding

- Cost of program: \$10.50 / individual / week plus supplies, overhead
- Approximately \$163K for rest of school year
- First two weeks of screening funded by School Committee, PTO, and Harvard Teachers Association
- After that, screening funded by donations
- Donors → [covid safeschools.org](https://covid safeschools.org) → Gifts to school system



**HARVARD SCHOOLS T•R•U•S•T**

Enhancing education at Hildreth Elementary School and the Bromfield School in Harvard, Massachusetts



Visit [covid safeschools.org](https://covid safeschools.org) for more funding information

# Testimonial

“Our experience has been exceptional. . . . We have been testing weekly since August, with literally no issues.”

“I cannot imagine trying to do this effort to reopen school and keep our students and employees safe without the partnership with CIC.”

Charles B. McCullagh, Jr., CFO  
The Williston Northampton School

